

Max - Flex™ Operators
 Operadores Max-Flex™
 Opérateurs Max-Flex™

For Use With Frame NG, PG
 Para Usar Con Caja Base NG, PG

Installation Instructions / Instructivo de Instalación

	Danger	Peligro	Danger
	<p>Hazardous Voltage. Will cause death or serious injury. Turn off and lock out all power supplying this device before working on this device. Replace all covers before power supplying this device is turned on.</p>	<p>Tensión peligrosa. Puede causar la muerte o lesiones graves. Desenergice totalmente antes de instalar o darle servicio. Reemplace todas las barreras y cubiertas antes de energizar el interruptor.</p>	<p>Tension dangereuse. Danger de mort ou risque de blessures graves. Couper l'alimentation de l'appareil et barrer avant de travailler. Remplacez tous les couverts avant que l'alimentation de pouvoir soit alimenté.</p>

Use only with Siemens certified Components.
 Utilizar únicamente con componentes certificados de Siemens.
 A utiliser uniquement avec les composants certifiés Siemens.

MFHP3RS	Suitable For Type 1,2,3,3R,12,12K enclosures [Apto par tipo 1,2,3,3R,12,12K caja]
MFHP3RSB	Suitable For Type 1,2,3,3R,12,12K enclosures [Apto par tipo 1,2,3,3R,12,12K caja]
MFHP4X	Suitable For Type 1,2,3,3R,4,4X,12,12K enclosures [Apto par tipo 1,2,3,3R,4,4X,12,12K caja]

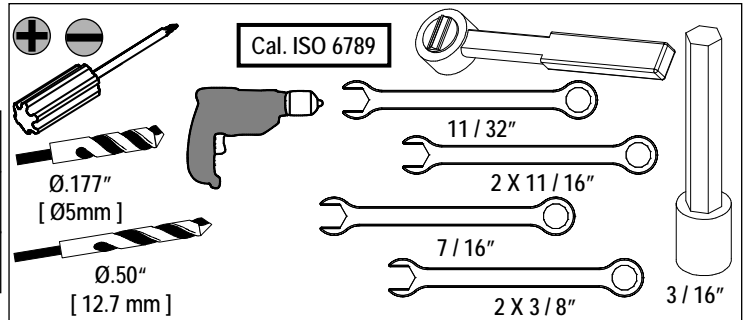

NOTE - These instructions do not purport to cover all details or variations in equipment, or to provide for every possible contingency to be met in connection with installation, operation or maintenance. Should further information be desired or should particular problems arise, which are not covered sufficiently for the purchaser's purposes, the matter should be referred to the local Siemens sales office. The contents of this instruction manual shall not become part of or modify any prior or existing agreement, commitment or relationship. The sales contract contains the entire obligation of Siemens. The warranty contained in the contract between the parties is the sole warranty of Siemens. Any statements contained herein do not create new warranties or modify the existing warranty.

Trademarks - Unless otherwise noted, all names identified by ® are registered trademarks of Siemens AG or Siemens Industry, Inc. The remaining trademarks in this publication may be trademarks whose use by third parties for their own purposes could violate the rights of the owner.

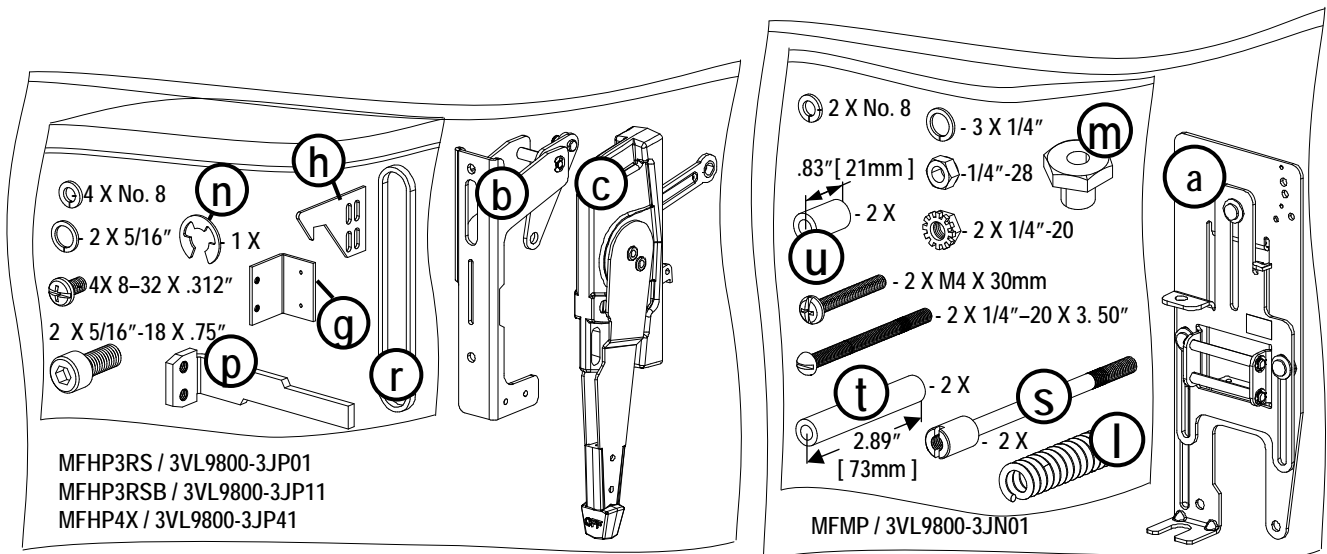

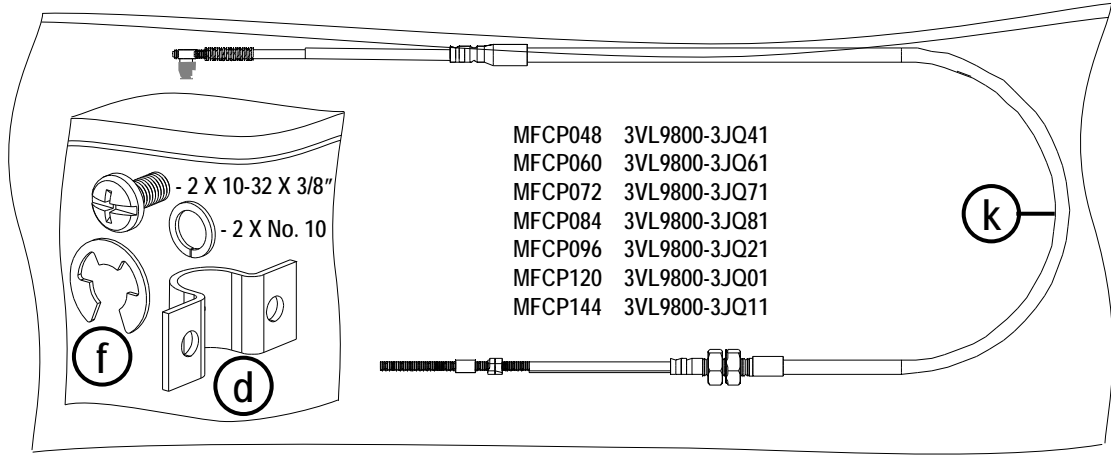
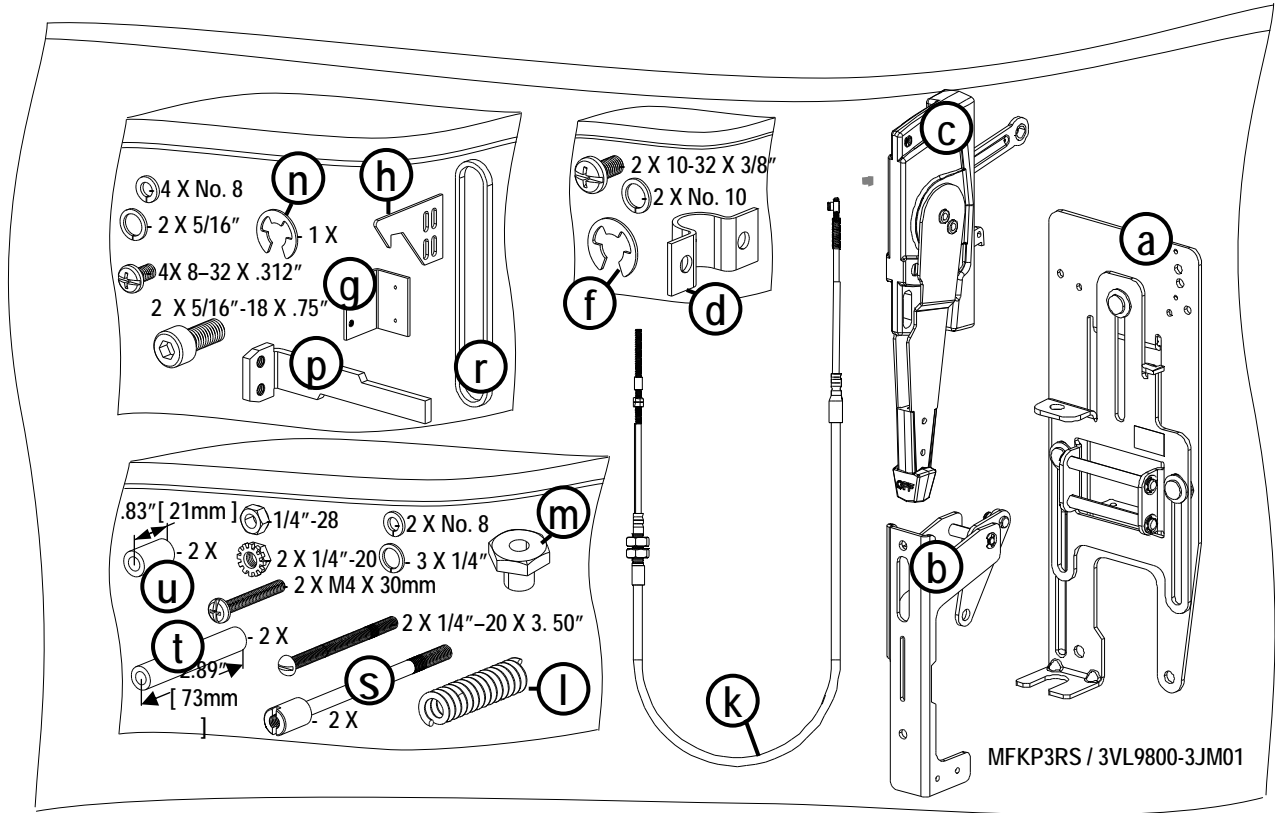



Danger

Hazardous Voltage.
Will cause death or serious injury.

Turn off and lock out all power supplying this device before working on this device.
Replace all covers before power supplying this device is turned on.



Peligro

Tensión peligrosa.
Puede causar la muerte o lesiones graves.

Desenergice totalmente antes de instalar o darle servicio.
Reemplace todas las barreras y cubiertas antes de energizar el interruptor.

Danger

Tension dangereuse.
Danger de mort ou risque de blessures graves.

Couper l'alimentation de l'appareil et barrer avant de travailler.
Remplacez tous les couverts avant que l'alimentation de pouvoir soit alimenté.

Dimensions for Welded or Screw mounting the cover catch. **[Dimensiones para soldar o atornillar el seguro de la puerta.]**

1

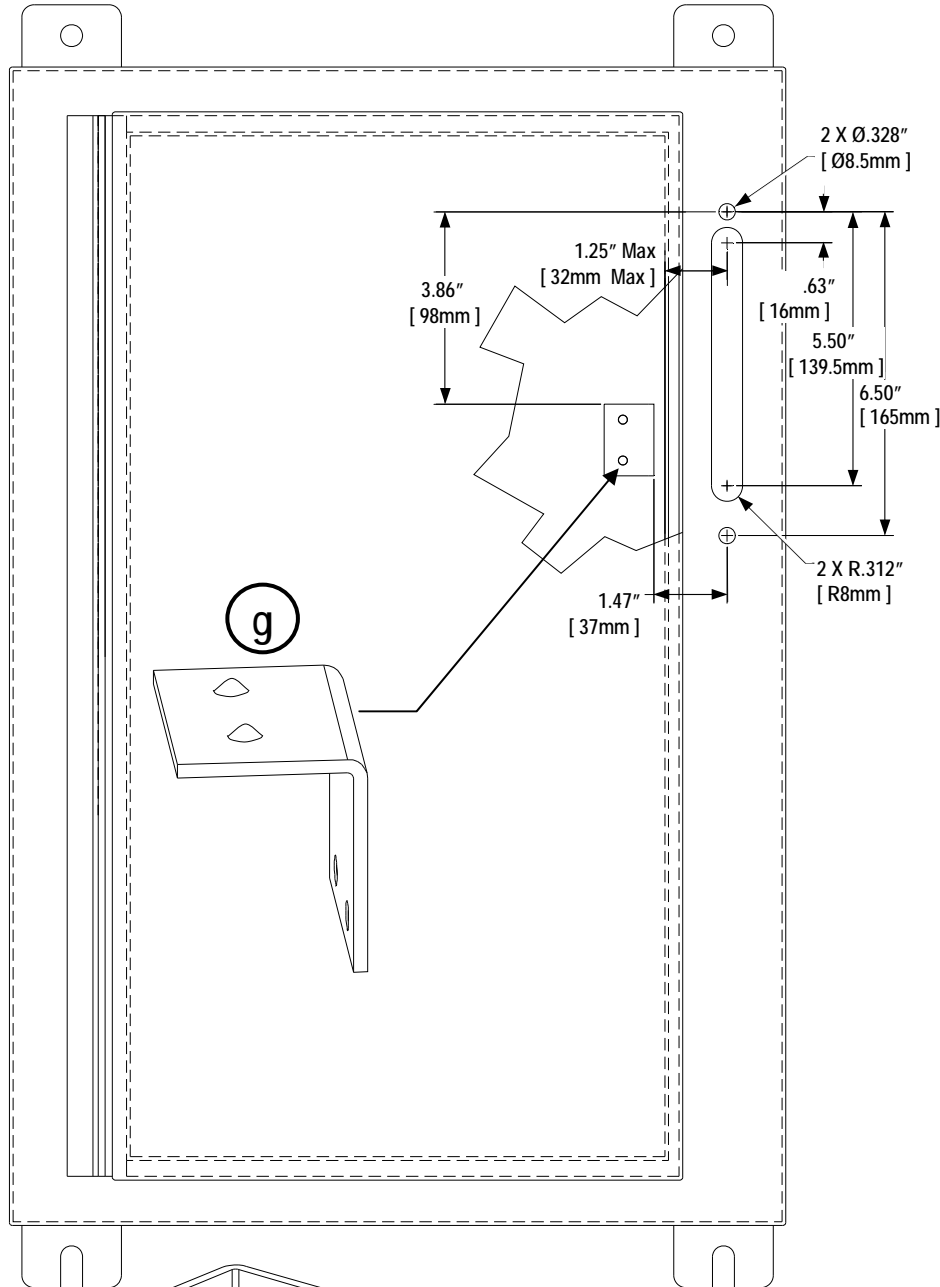

Option:
[Opción:]

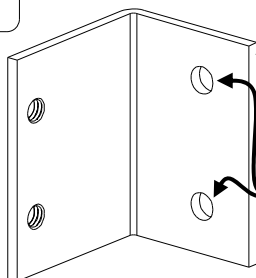

2X Ø.177"
[2X Ø5mm]

Customer supplied hardware for screw mounting option. Hardware must maintain environmental integrity (NEMA rating) of the enclosure.
[Material de montaje provisto por el cliente. Montaje por tornillo el material para montaje debe mantener la integridad ambiental (la grado NEMA) en la caja.]

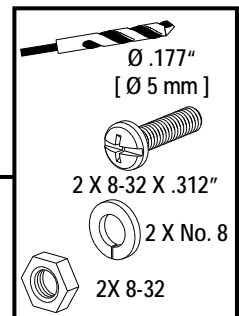

2

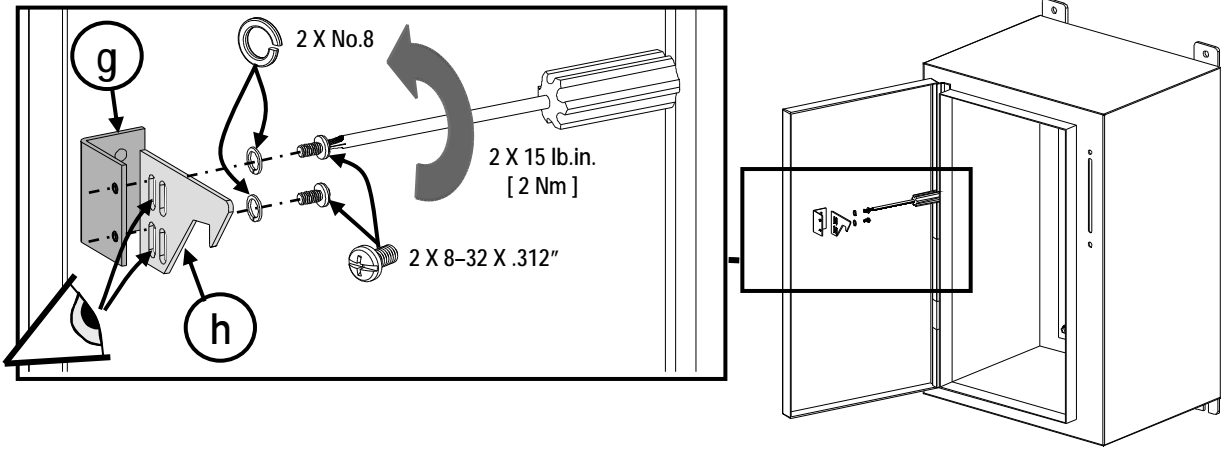

3

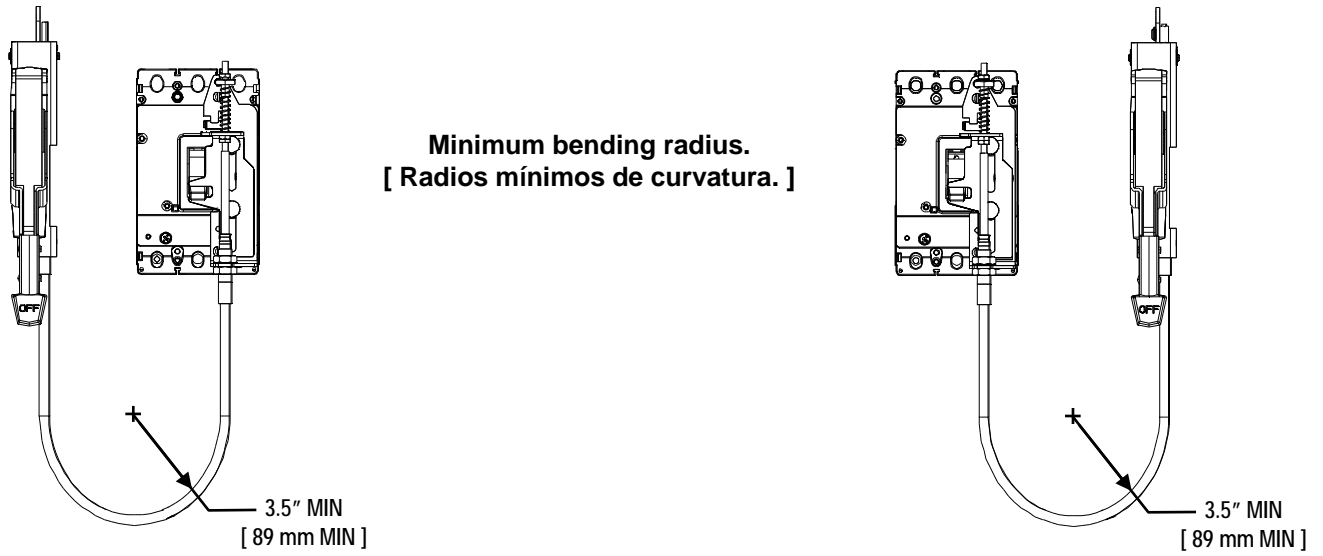

For left hand side mounting and right hand side mounting
[Para montaje de lado izquierdo y lado derecho]

4

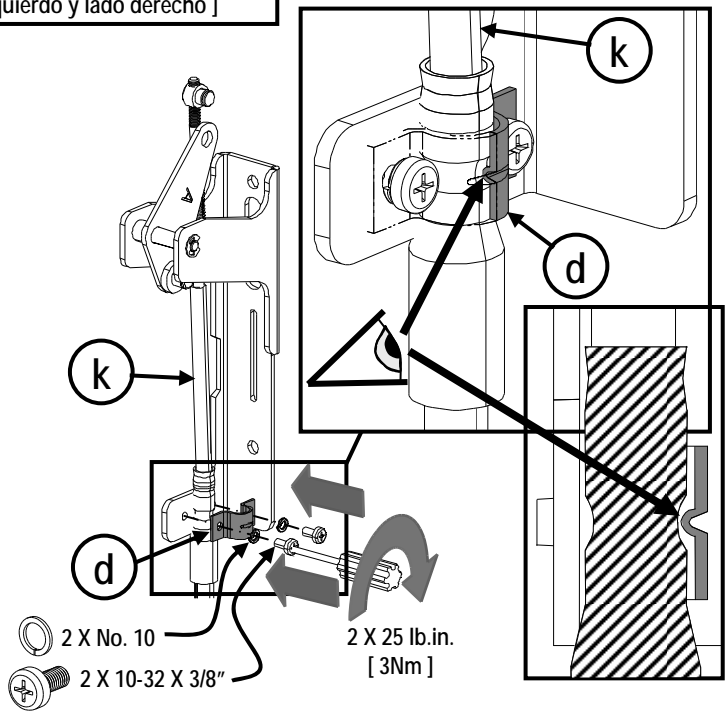



⚠ Danger

Hazardous Voltage.
Will cause death or serious injury.



Turn off and lock out all power supplying this device before working on this device.
Replace all covers before power supplying this device is turned on.

⚠ Peligro

Tensión peligrosa.
Puede causar la muerte o lesiones graves.

Desenergice totalmente antes de instalar o darle servicio.
Reemplace todas las barreras y cubiertas antes de energizar el interruptor.

⚠ Danger

Tension dangereuse.
Danger de mort ou risque de blessures graves.

Couper l'alimentation de l'appareil et barrer avant de travailler.
Remplacez tous les couverts avant que l'alimentation de pouvoir soit alimenté.

5

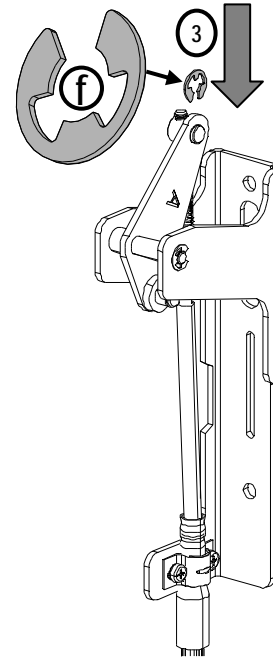
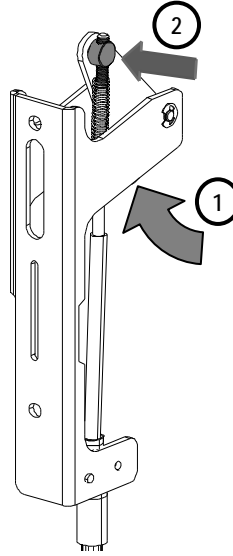
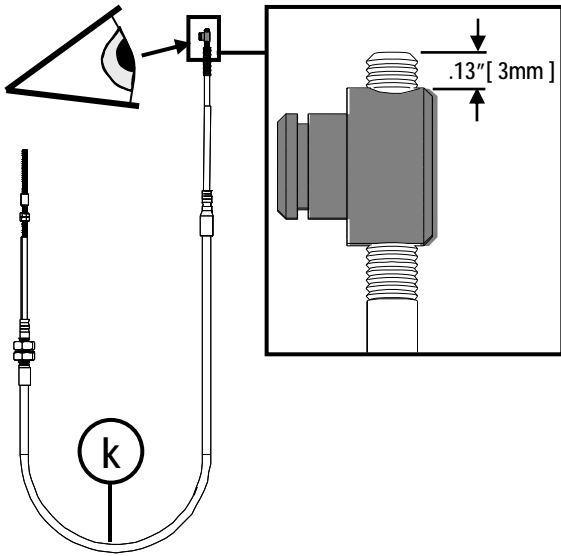

6

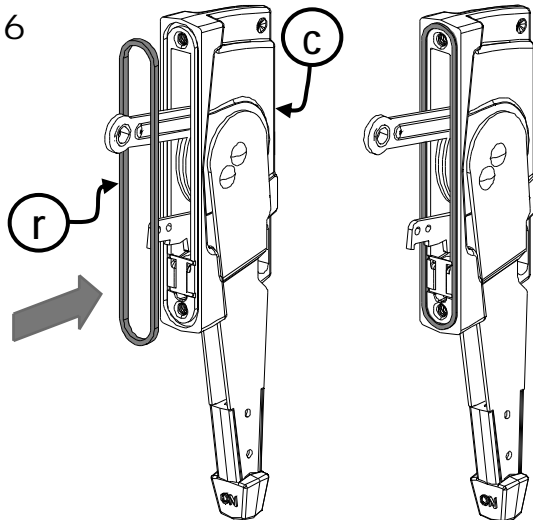

7

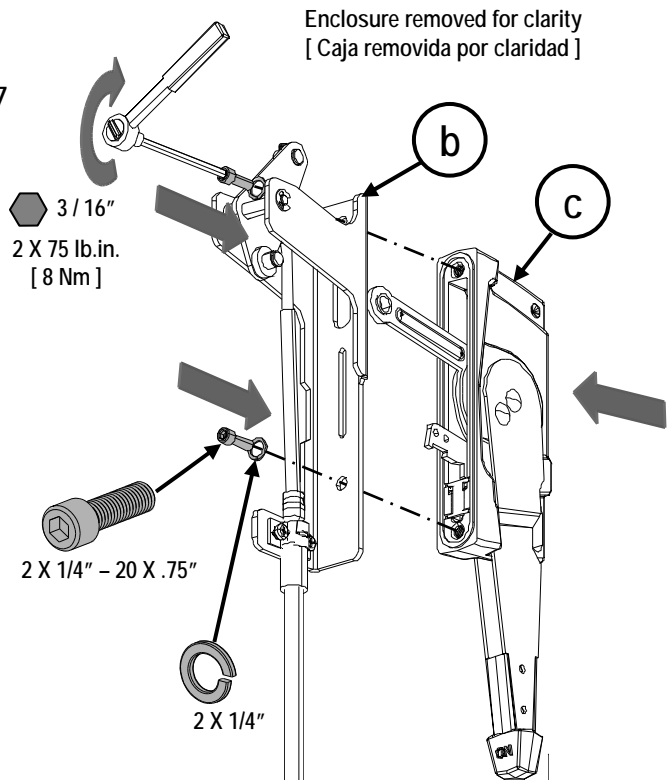

For left hand side mounting and right hand side mounting
 [Para montaje de lado izquierdo y lado derecho]

8

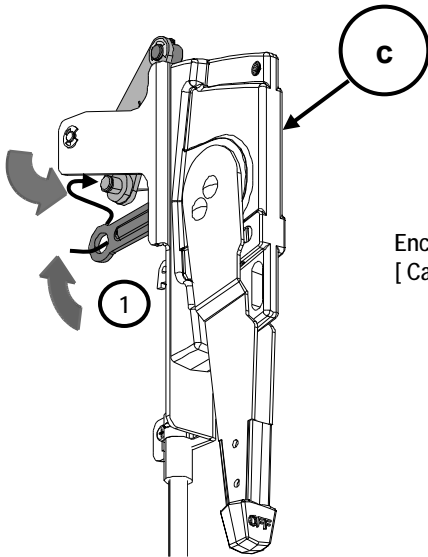

Enclosure removed for clarity
 [Caja removida por claridad]

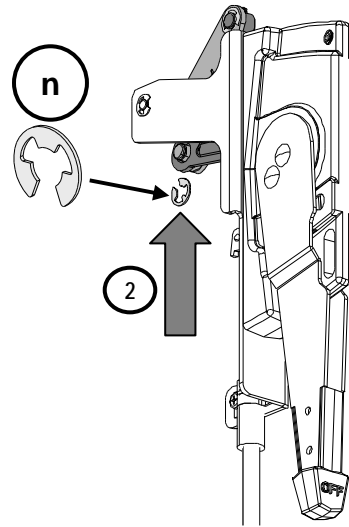

9

left hand side mounting
 [montaje de lado izquierda]

Enclosure removed for clarity
 [Caja removida por claridad]

right hand side mounting
 [montaje de lado derecho]

Enclosure removed for clarity
 [Caja removida por claridad]

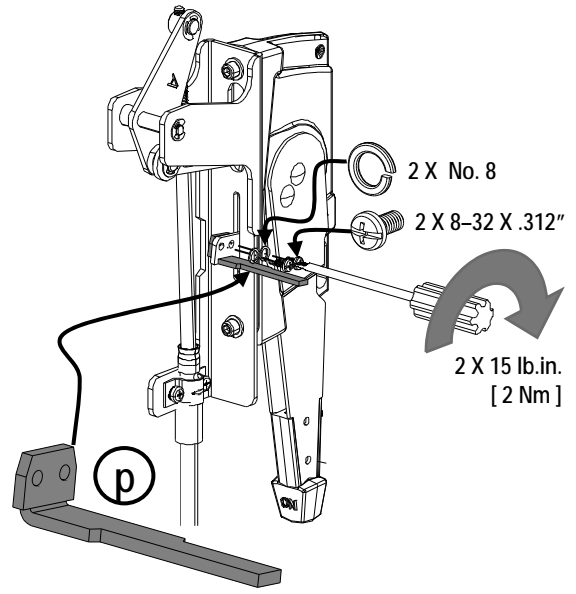
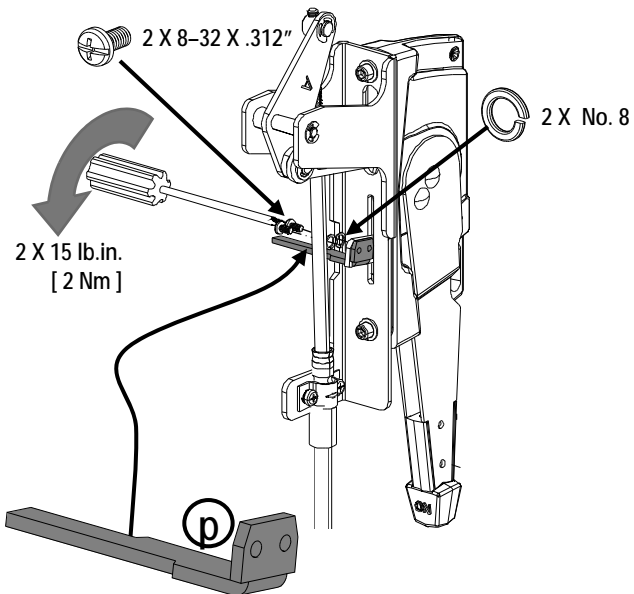



Danger

Hazardous Voltage.
Will cause death or serious injury.
 Turn off and lock out all power supplying this device before working on this device.
 Replace all covers before power supplying this device is turned on.



Peligro

Tensión peligrosa.
Puede causar la muerte o lesiones graves.
 Desenergice totalmente antes de instalar o darle servicio.
 Reemplace todas las barreras y cubiertas antes de energizar el interruptor.

Danger

Tension dangereuse.
Danger de mort ou risque de blessures graves.
 Couper l'alimentation de l'appareil et barrer avant de travailler.
 Remplacez tous les couverts avant que l'alimentation de pouvoir soit alimenté.

10

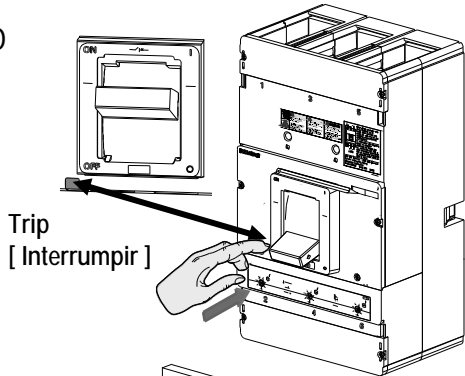

12

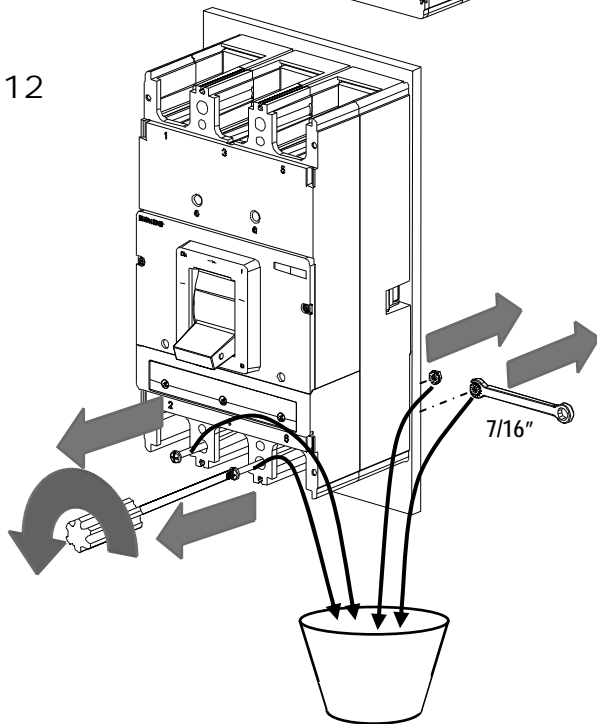

14

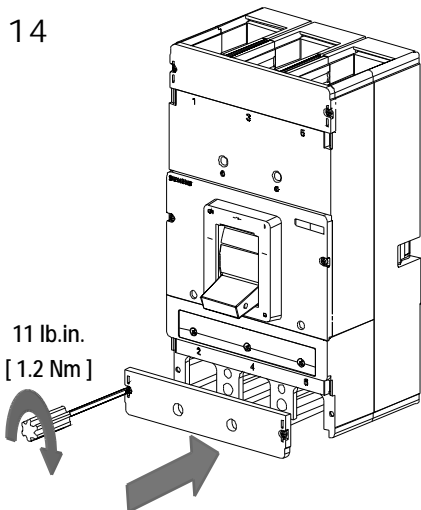

11

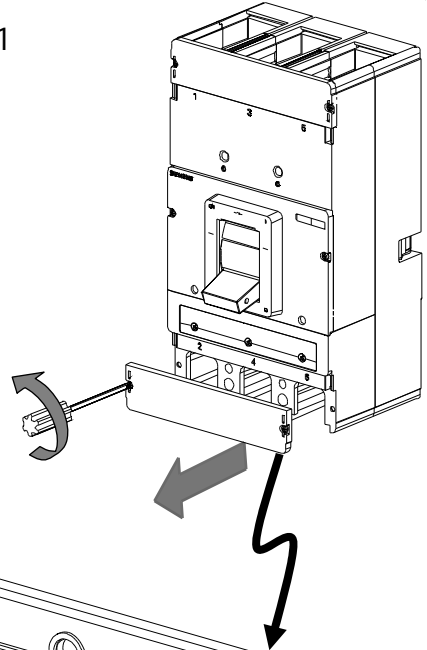

13

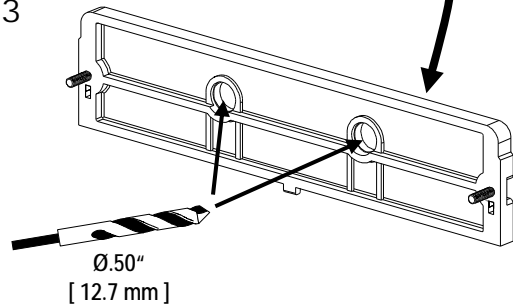

15

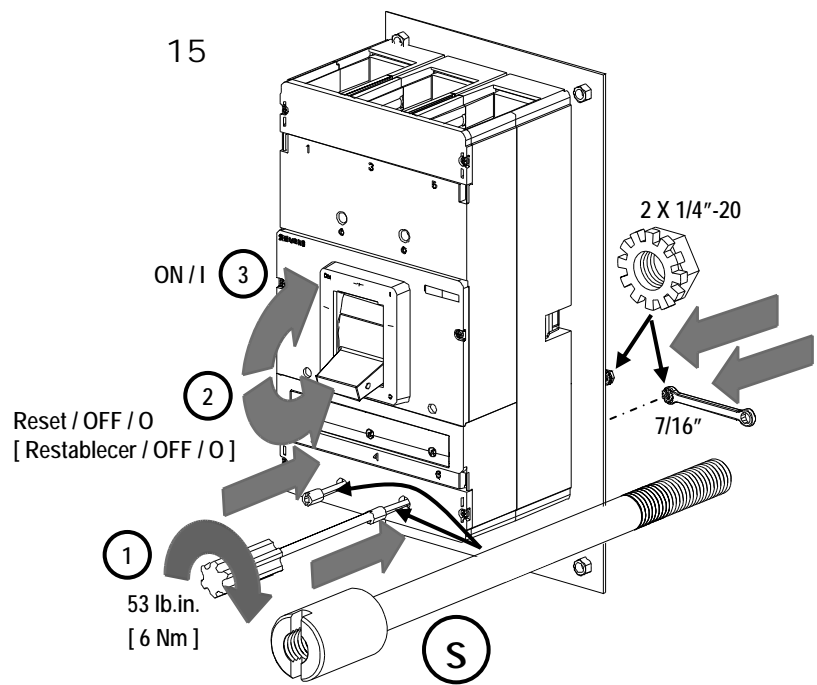



Danger

Hazardous Voltage.
Will cause death or serious injury.



Turn off and lock out all power supplying this device before working on this device.
Replace all covers before power supplying this device is turned on.

Peligro

Tensión peligrosa.
Puede causar la muerte o lesiones graves.

Desenergice totalmente antes de instalar o darle servicio.
Reemplace todas las barreras y cubiertas antes de energizar el interruptor.

Danger

Tension dangereuse.
Danger de mort ou risque de blessures graves.

Couper l'alimentation de l'appareil et barrer avant de travailler.
Remplacez tous les couverts avant que l'alimentation de pouvoir soit alimenté.

19

.25"
[6.35mm]

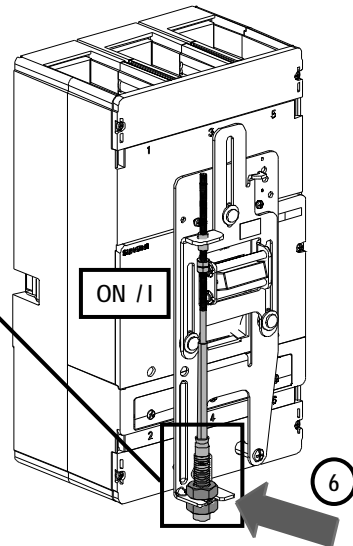
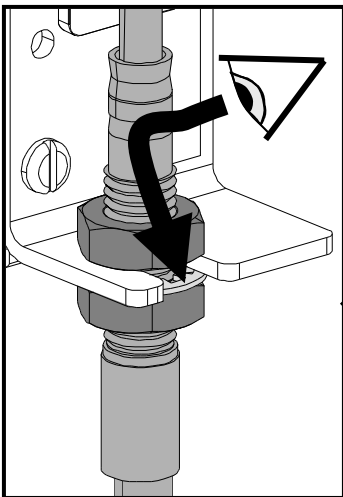
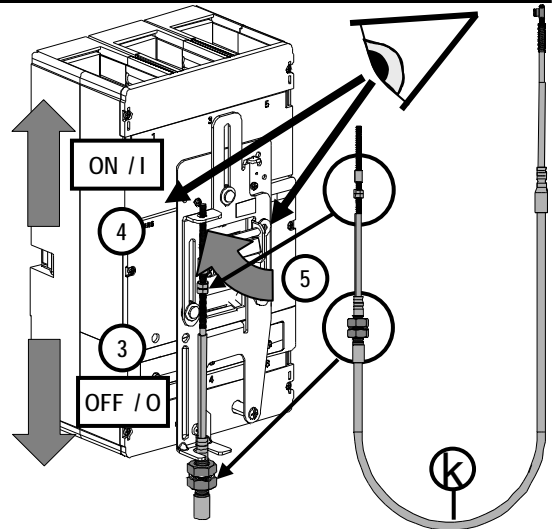
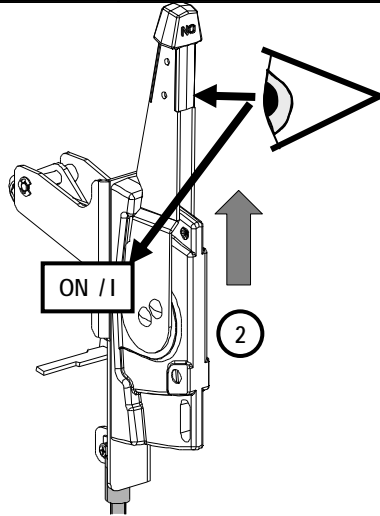
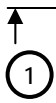

20

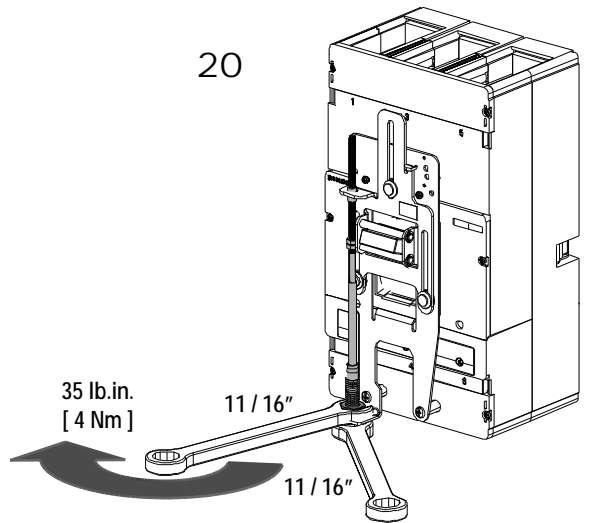

21

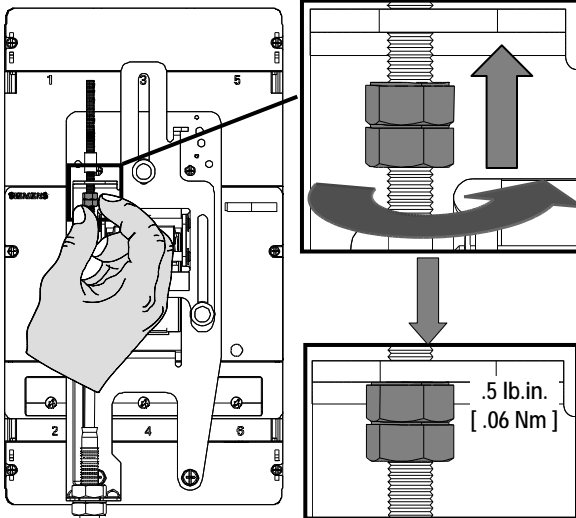

22

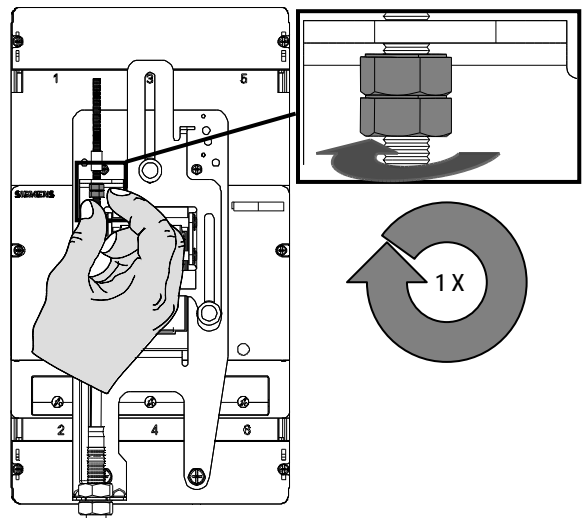

23

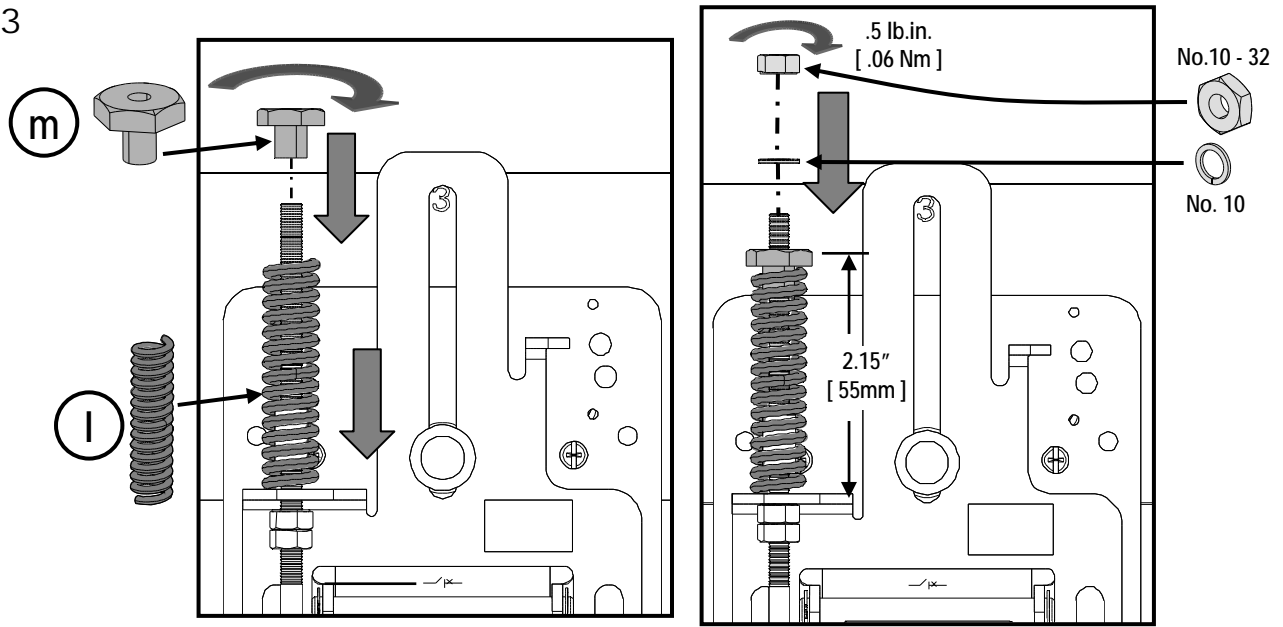

Test: ON / I – OFF / O
 [Prueba: ON / I – OFF / O]

24

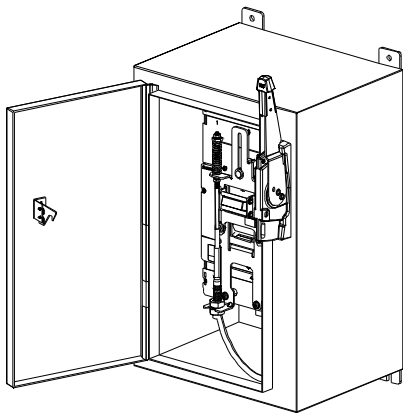

		Result [Resultado]		Go To [Ir Al]
24a	ON / I	OFF / O		Test 24b [Prueba 24b]
		ON / I		Step 25 [Paso 25]
24b	OFF / O	ON / I		Step 27 [Paso 27]
		OFF / O		Step 26 [Paso 26]

25

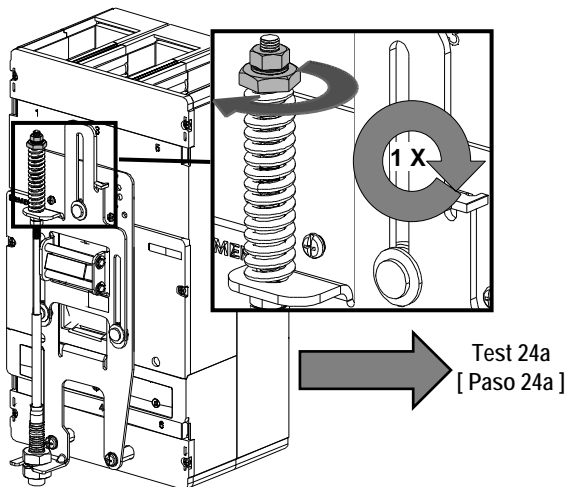

26

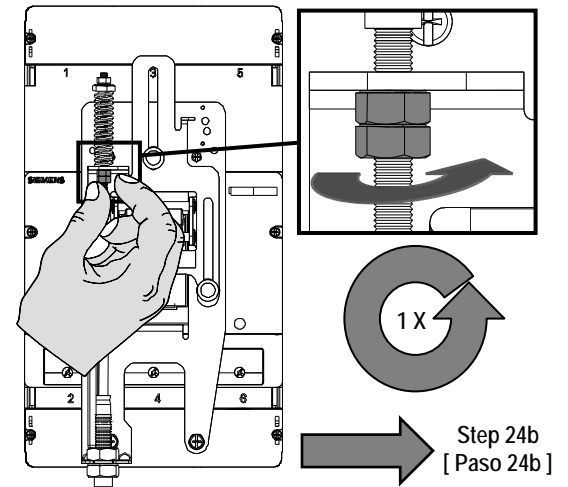



Danger

Hazardous Voltage.
Will cause death or serious injury.

Turn off and lock out all power supplying this device before working on this device.
Replace all covers before power supplying this device is turned on.

Peligro

Tensión peligrosa.
Puede causar la muerte o lesiones graves.

Desenergice totalmente antes de instalar o darle servicio.
Reemplace todas las barreras y cubiertas antes de energizar el interruptor.

Danger

Tension dangereuse.
Danger de mort ou risque de blessures graves.

Couper l'alimentation de l'appareil et barrer avant de travailler.
Remplacez tous les couverts avant que l'approvisionnement de pouvoir soit alimenté.

27

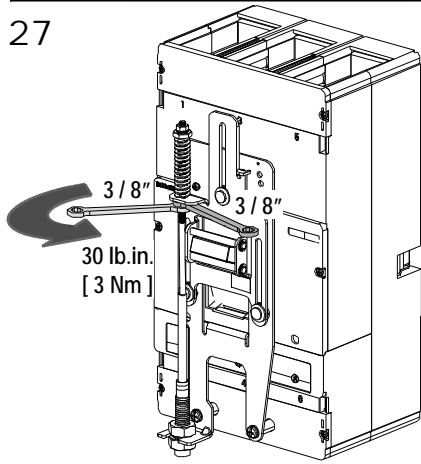

Test: Trip – Reset - ON / I **[Prueba: Interrumpir – Restablecer - ON / I]**

28

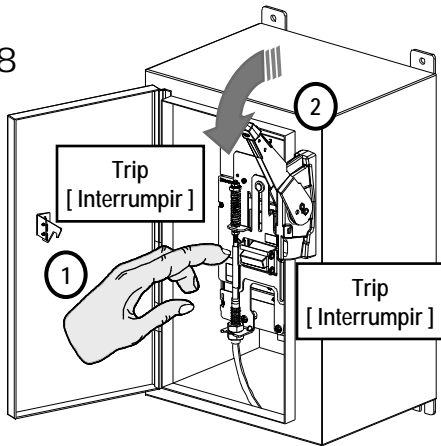

29

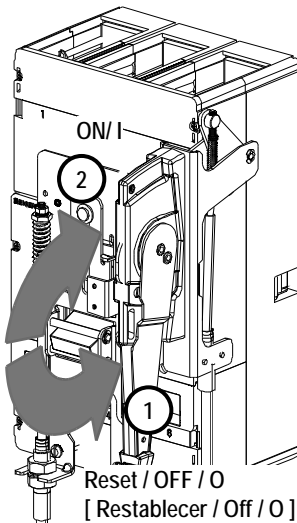

	Result [Resultado]	Go To Step [Ir Al Paso]	
29a	OFF / O → ON / I	OK	31
		OK	30

30

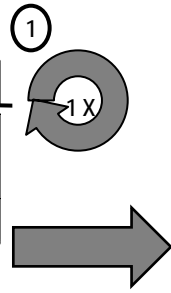
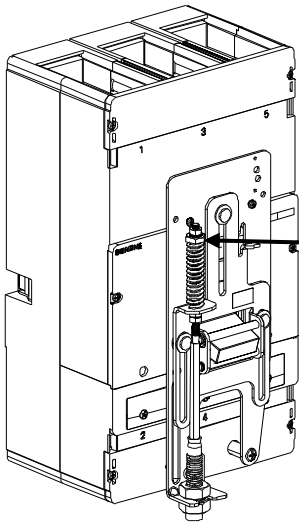

Step 29a
[Paso 29a]

31

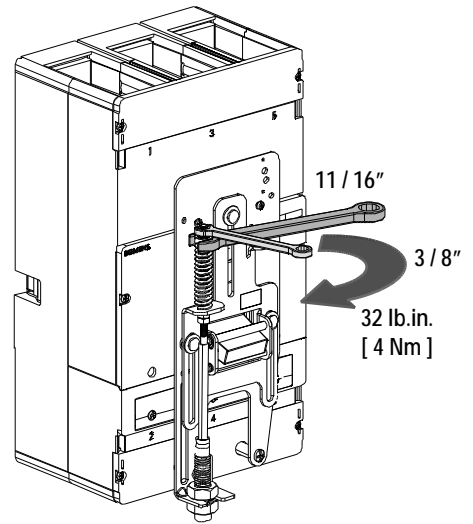

	Danger	Peligro	Danger
	Hazardous Voltage. Will cause death or serious injury.	Tensión peligrosa. Puede causar la muerte o lesiones graves.	Tension dangereuse. Danger de mort ou risque de blessures graves.
	Turn off and lock out all power supplying this device before working on this device. Replace all covers before power supplying this device is turned on.	Desenergice totalmente antes de instalar o darle servicio. Reemplace todas las barreras y cubiertas antes de energizar el interruptor.	Couper l'alimentation de l'appareil et barrer avant de travailler. Remplacez tous les couverts avant que l'alprovisionnement de pouvoir soit alimenté.

Test: Door Latch

[Prueba: Seguro de la Puerta]



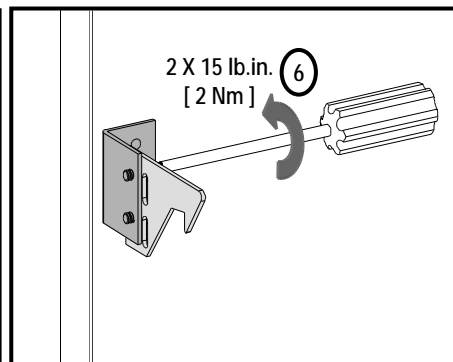
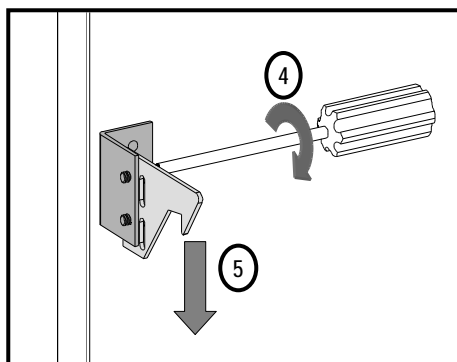

32			Result [Resultado]		Step [Paso]
			 Open [Abierta]	 Closed [Cerrados]	
	OFF/O ON/I	5 lbf [22 N]			34
					33

33

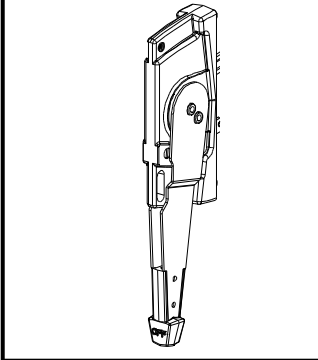
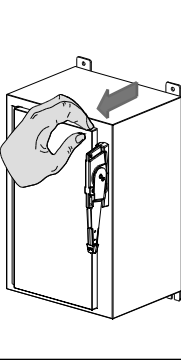
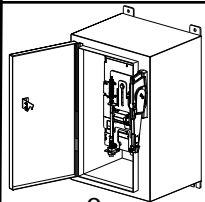
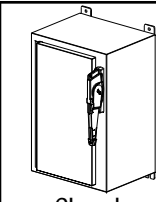

Step 32
[Paso 32]

	⚠ Danger	⚠ Peligro	⚠ Danger
	Hazardous Voltage. Will cause death or serious injury.	Tensión peligrosa. Puede causar la muerte o lesiones graves.	Tension dangereuse. Danger de mort ou risque de blessures graves.
	Turn off and lock out all power supplying this device before working on this device. Replace all covers before power supplying this device is turned on.	Desenergice totalmente antes de instalar o darle servicio. Reemplace todas las barreras y cubiertas antes de energizar el interruptor.	Couper l'alimentation de l'appareil et barrer avant de travailler. Remplacez tous les couverts avant que l'alprovisionnement de pouvoir soit alimenté.

34			Result [Resultado]		Step [Paso]
			 Open [Abierta]	 Closed [Cerrados]	
	ON / I  OFF / O	5 lbf [22 N]			Finished / Ready [Terminado / Listo]
					35

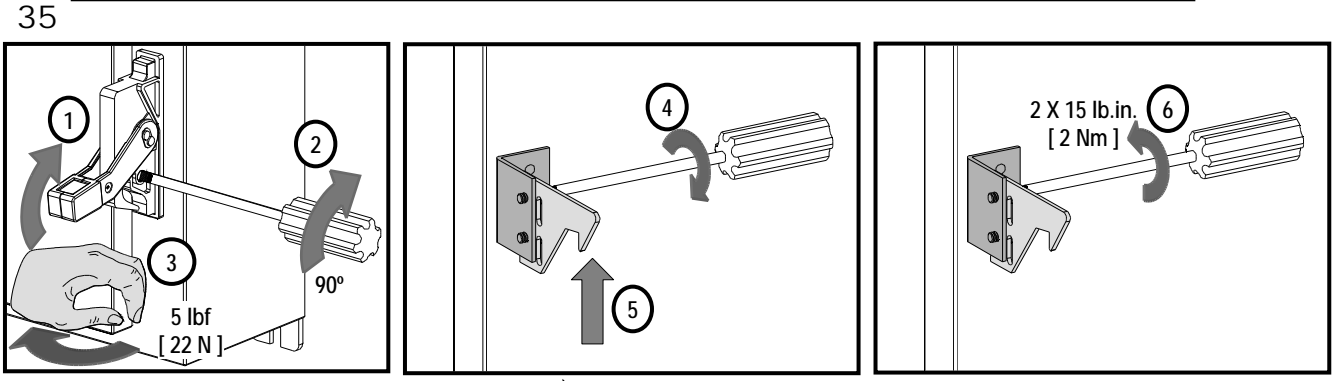

 Step 34
[Paso 34]

Option:
[Opción:]

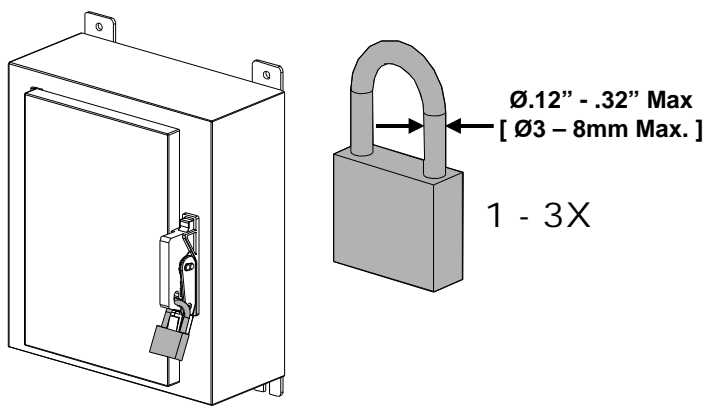

Bestell-Nr. / Order No.: 3ZX1012-0VL68-7AA8	For Support in Europe refer to : Internet: www.siemens.de/lowvoltage/technical-assistance	GWA 4NEB 179 6899-10 DS 03
---	--	----------------------------

Technical Support:	Toll Free: 1-800-241-4453	Internet: www.usa.siemens.com/powerdistribution
--------------------	---------------------------	--